

8RP 80 & 8RP 98 SERIES PUMP DESIGN

Material Specification

No	PART NAME	MATERIAL
1	DISCHARGE CHAMBER HOUSING	STEEL CAST 304
2	SPRING	S.S.302
3	VALVE	S.S.304
4	VALVE SEAT	N.B.R.
5	"O" RING	N.B.R.
6	VALVE SEAT HOUSING	STEEL CAST 304
7	FIRST STAGE BEARING BUSH	N.B.R. + S.S.304
8	STOP RING	S.S.304
9	SPACING WASHER	25% CFT
10	FIRST STAGE NUT	STEEL CAST 304
11	IMPELLER COLLET	S.S.304
12	BEARING BUSH STAGE	N.B.R.
13	COLLET NUT	S.S.304
14	NECKRING	N.B.R. + NYLON
15	IMC SLEEVE	S.S.304
16	INTERMEDIATE CHAMBER	S.S.304
17	IMPELLER	S.S.304
18	PUMP SHAFT (UP TO 04 STAGES)	S.S.431
	PUMP SHAFT (05 STAGE & ABOVE)	S.S.1.4362
19	NEMA COUPLING	S.S.304
20	STRAINER	S.S.304
21	CLAMPING STRIP	S.S.304
22	HEX NUT	S.S.316
23	CABLE GUARD	S.S.304
24	SUCTION	STEEL CAST 304

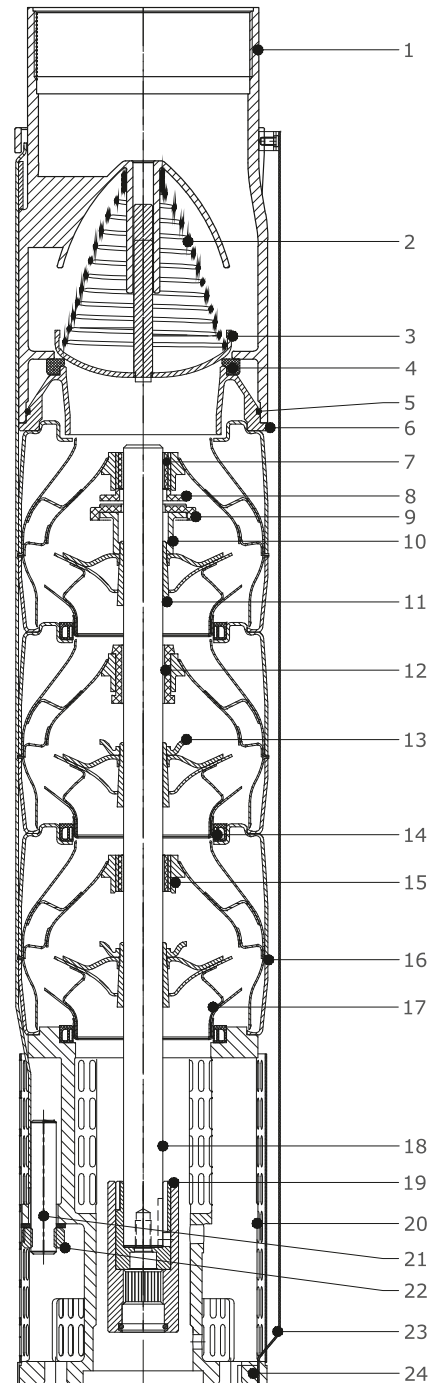

PERFORMANCE CURVES

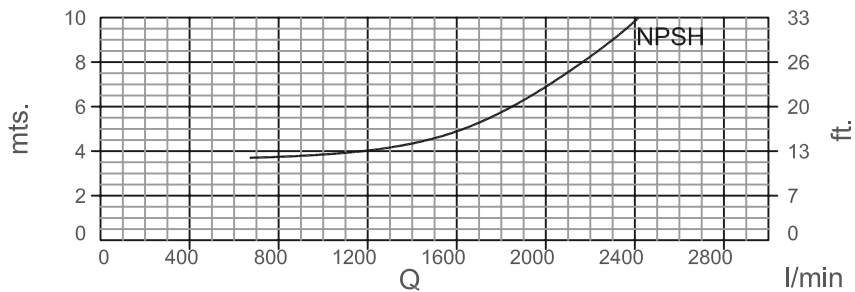
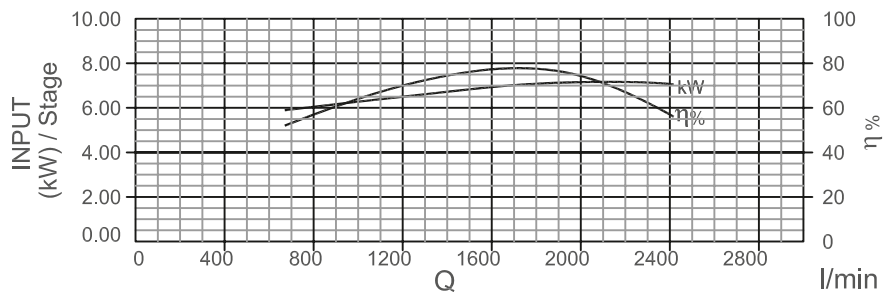
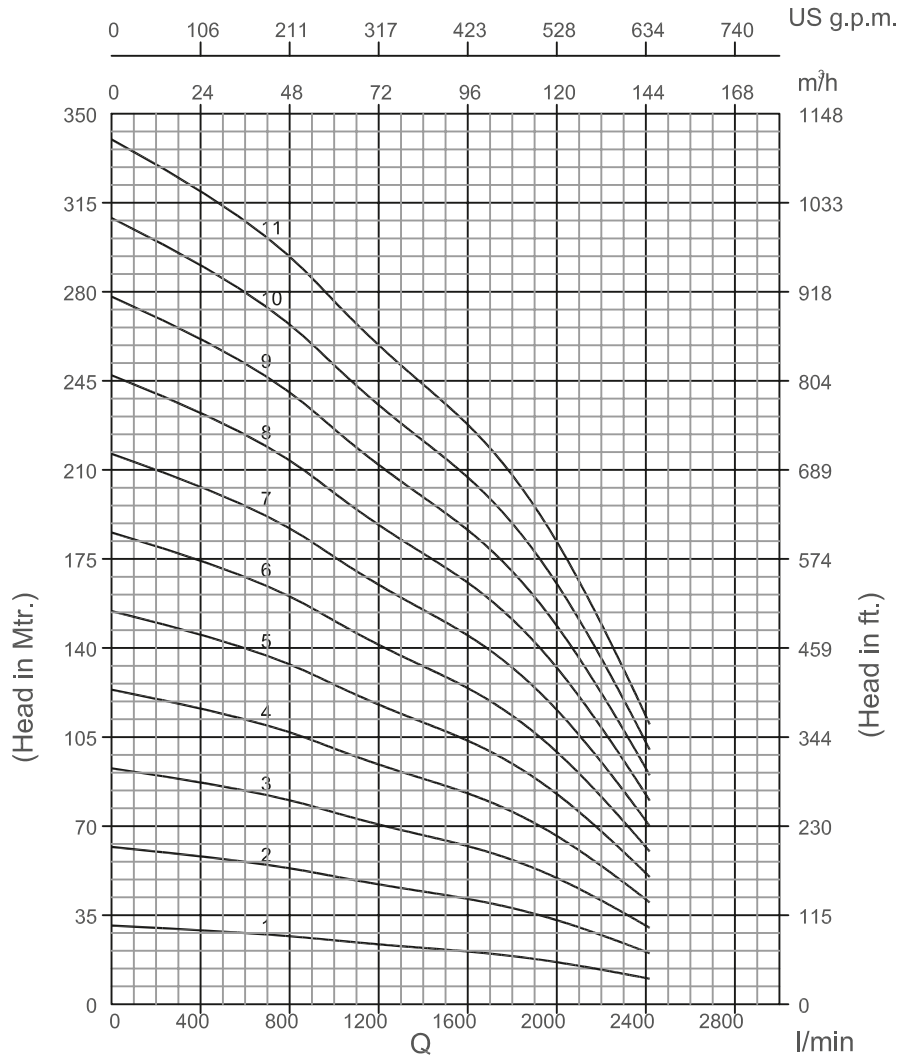

8RP 80, 60Hz ISO 9906 Annexure A

PERFORMANCE CHART

MODEL NAME	STAGE	RATING		DISCHARGE										
		kW	HP		l/min	0	335	670	1000	1166	1335	1500	1670	1835
THREE PHASE				m ³ /h	0	20.1	40.2	60.0	70.0	80.1	90.0	100.2	110.1	120.0
8RP 80-01	1	5.50	7.50	HEAD IN M trs.	29.5	29	27	23	22	20	19	17	14	11
8RP 80-02	2	11.00	15.00		59	58	53	47	44	41	38	34	28	22
8RP 80-03	3	18.50	25.00		88	87	80	70	66	61	57	50	42	32
8RP 80-04	4	22.00	30.00		118	115	106	94	88	82	75	67	55	43
8RP 80-05	5	26.00	35.00		147	144	133	117	110	102	94	84	69	54
8RP 80-06	6	37.00	50.00		177	173	159	141	132	122	113	101	83	65
8RP 80-07	7	37.00	50.00		206	202	186	164	153	143	132	117	97	75
8RP 80-08	8	45.00	60.00		236	231	212	188	175	163	151	134	111	86
8RP 80-09	9	55.00	75.00		265	260	239	211	197	183	170	151	125	97
8RP 80-10	10	55.00	75.00		294	288	265	235	219	204	188	168	138	108
8RP 80-11	11	63.00	85.00		324	317	292	258	241	224	207	184	152	118
8RP 80-12	12	63.00	85.00		353	346	318	282	263	245	226	201	166	129
8RP 80-13	13	75.00	100.0		383	375	345	305	285	265	245	218	180	140

Dimensions & Weights

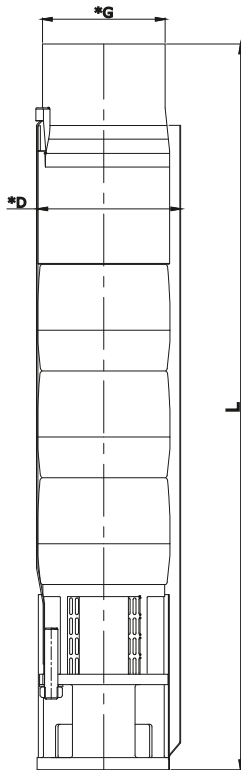

Model Name	Specification				
	D* (mm)	D** (mm)	L (mm)	Pump Weight (in Kg.)	Weight (Incl. pkg.) Kg.
8RP 80 - 01	175	180	620	21	23
8RP 80 - 02	175	180	748	25	28
8RP 80 - 03	175	180	876	29	32
8RP 80 - 04	175	180	1004	33	36
8RP 80 - 05	175	180	1132	37	41
8RP 80 - 06	175	180	1260	41	45
8RP 80 - 07	175	180	1388	45	50
8RP 80 - 08	196	200	1516	49	54
8RP 80 - 09	196	200	1644	53	58
8RP 80 - 10	196	200	1772	55	63
8RP 80 - 11	196	200	1900	59	67
8RP 80 - 12	196	200	2028	63	72
8RP 80 - 13	196	200	2156	67	76

* G: Available Outlet Size 5" NPT

* D: Maximum Diameter With Single Cable Guard

** D: Maximum Diameter With Double Cable Guard upto 50 HP 6" Motor Joining

8RP 80 -01 to 8RP 80 -07 pump are available in 6" joining.
8RP 80 -08 to 8RP 80 -13 pump are available in 8" joining.

PERFORMANCE CURVES

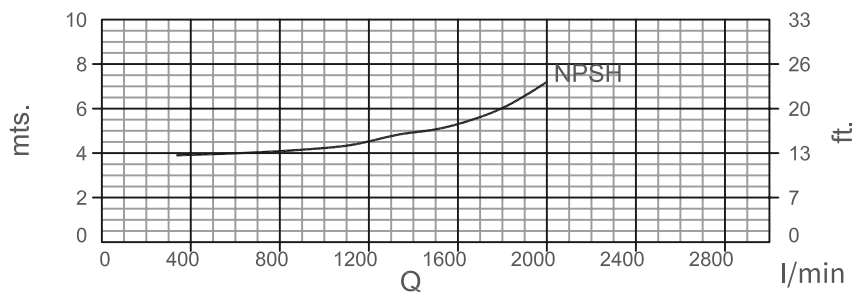
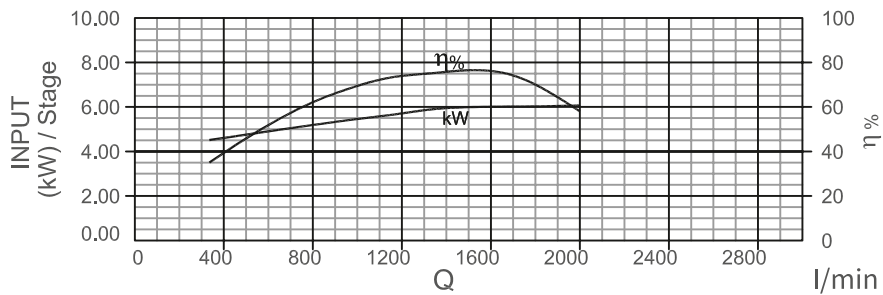
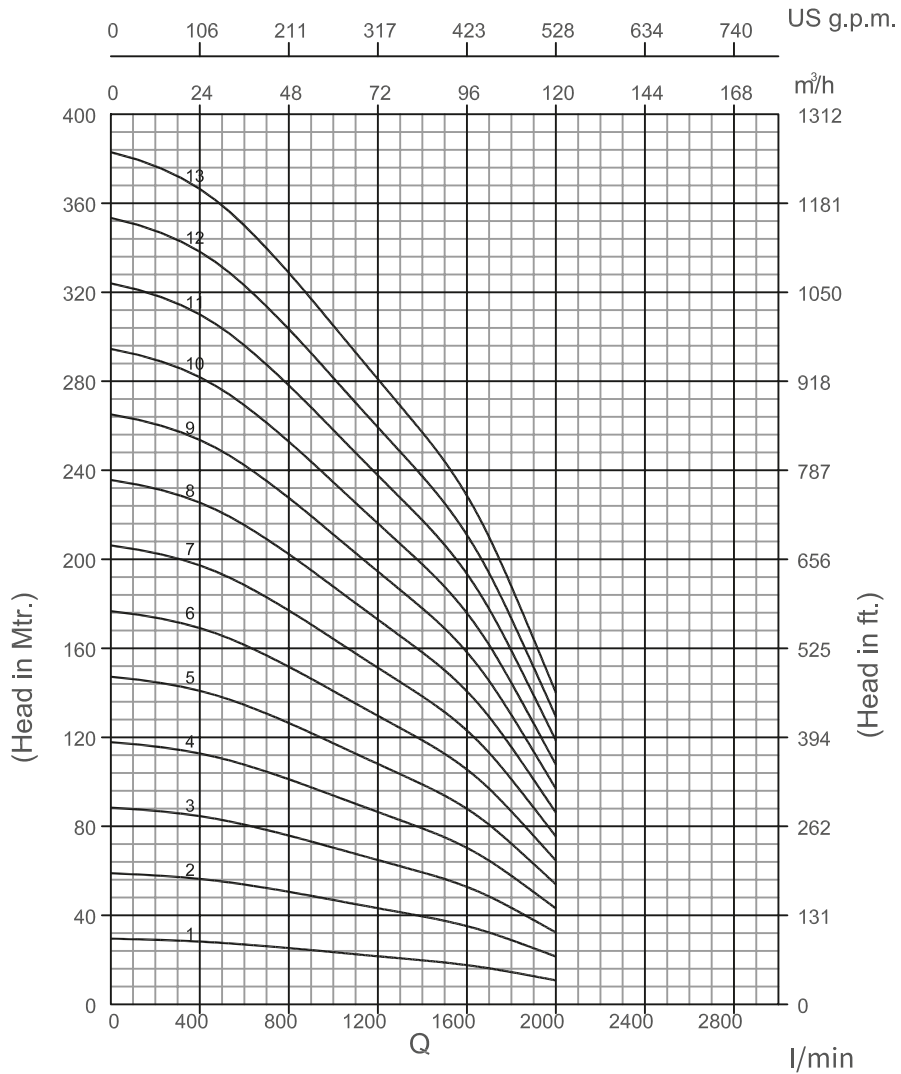

8RP 98, 60Hz
ISO 9906 Annexure A

PERFORMANCE CHART

MODEL NAME	STAGE	RATING		DISCHARGE								
		kW	HP	l/min	0	670	1000	1335	1670	2000	2335	2417
				m ³ /h	0	40.2	60.0	80.1	100.2	120.0	140.1	145.0

Model Name	Stage	kW	HP	HEAD IN Mtrs.	31	28	25	23	20	17	11	10	
8RP 98-01	1	7.50	10.00		62	56	50	45	41	34	23	20	
8RP 98-02	2	13.00	17.50		93	84	75	68	61	50	34	30	
8RP 98-03	3	22.00	30.00		124	112	100	90	81	67	46	40	
8RP 98-04	4	26.00	35.00		154	140	125	113	102	84	57	50	
8RP 98-05	5	37.00	50.00		185	168	150	135	122	101	69	60	
8RP 98-06	6	37.00	50.00		216	196	175	158	143	118	80	70	
8RP 98-07	7	45.00	60.00		247	224	200	180	163	135	92	80	
8RP 98-08	8	55.00	75.00		278	252	225	203	183	151	103	90	
8RP 98-09	9	63.00	85.00		309	280	250	225	204	168	114	100	
8RP 98-10	10	63.00	85.00		340	308	275	248	224	185	126	110	
8RP 98-11	11	75.00	100.0										

Dimensions & Weights

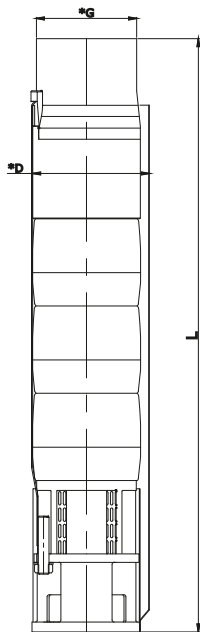

Model Name	Specification				
	D* (mm)	D** (mm)	L (mm)	Pump Weight (in Kg.)	Weight (Incl. pkg.) Kg.
8RP 98 - 01	175	180	620	21	23
8RP 98 - 02	175	180	748	25	28
8RP 98 - 03	175	180	876	29	32
8RP 98 - 04	175	180	1004	33	36
8RP 98 - 05	175	180	1132	37	41
8RP 98 - 06	175	180	1260	41	45
8RP 98 - 07	196	200	1388	45	50
8RP 98 - 08	196	200	1516	49	54
8RP 98 - 09	196	200	1644	53	58
8RP 98 - 10	196	200	1772	55	63
8RP 98 - 11	196	200	1900	59	67

* G: Available Outlet Size 5" NPT

* D: Maximum Diameter With Single Cable Guard

** D: Maximum Diameter With Double Cable Guard upto 50 HP 6" Motor Joining

8RP 98 -01 to 8RP 98 -06 pump are available in 6" joining.
8RP 98 -07 to 8RP 98 -11 pump are available in 8" joining.